

Soils Map

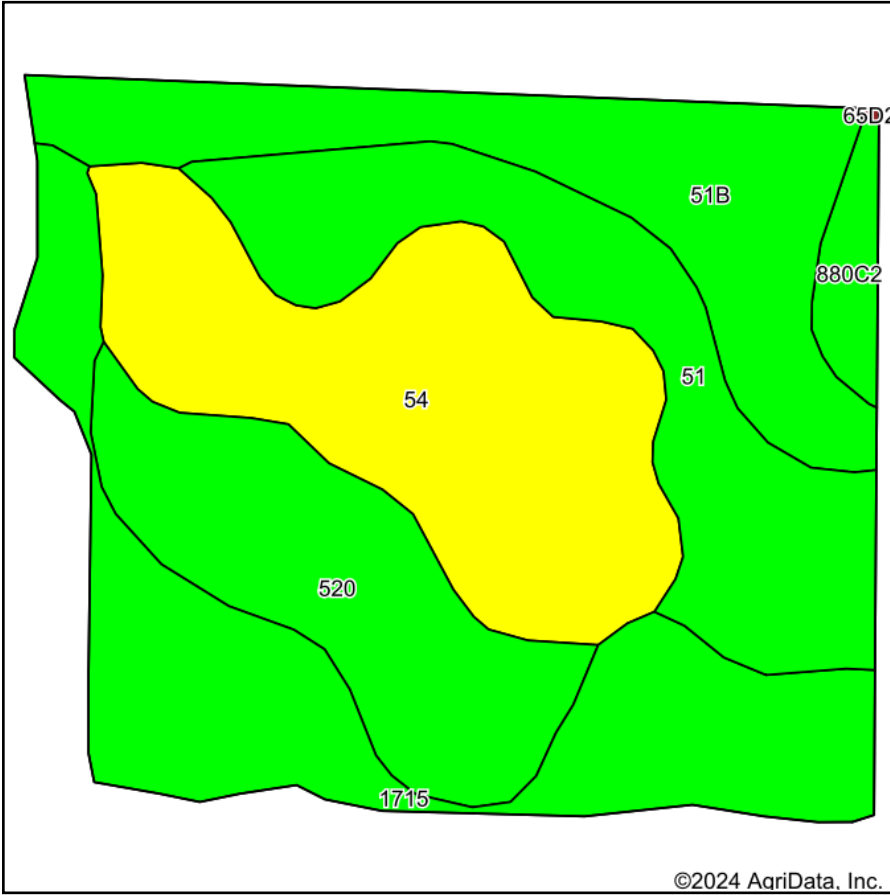

Soils data provided by USDA and NRCS.

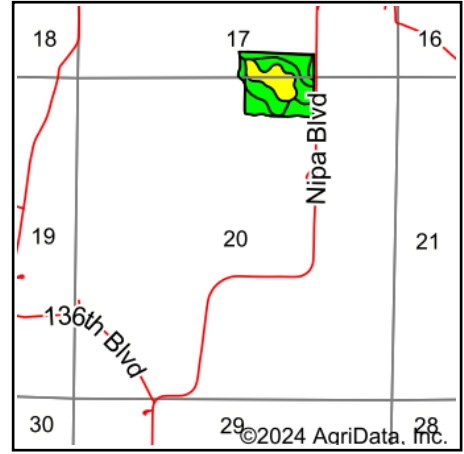

State: **Iowa**
 County: **Jefferson**
 Location: **17-73N-9W**
 Township: **Penn**
 Acres: **28.51**
 Date: **6/13/2024**



Maps Provided By:



© AgriData, Inc. 2023

www.AgriDataInc.com



Area Symbol: IA101, Soil Area Version: 31

Code	Soil Description	Acres	Percent of field	CSR2 Legend	Non-Irr Class *c	CSR2**	CSR	
54	Zook silty clay loam, 0 to 2 percent slopes, occasionally flooded	7.16	25.1%		Ilw	60	70	
1715	Nodaway-Vesser-Ackmore complex, 0 to 2 percent slopes	6.21	21.8%		Ilw	74	80	
51	Vesser silt loam, 0 to 2 percent slopes	5.13	18.0%		Ilw	74	70	
51B	Vesser silt loam, 2 to 5 percent slopes	4.90	17.2%		Ilw	74	65	
520	Coppock silt loam, 0 to 2 percent slopes	4.46	15.6%		Ilw	79	65	
880C2	Clinton silty clay loam, terrace, 5 to 9 percent slopes, eroded	0.65	2.3%		IIIe	71	60	
Weighted Average						2.02	71.2	70.3

**IA has updated the CSR values for each county to CSR2.

*c: Using Capabilities Class Dominant Condition Aggregation Method