

# Soils Map

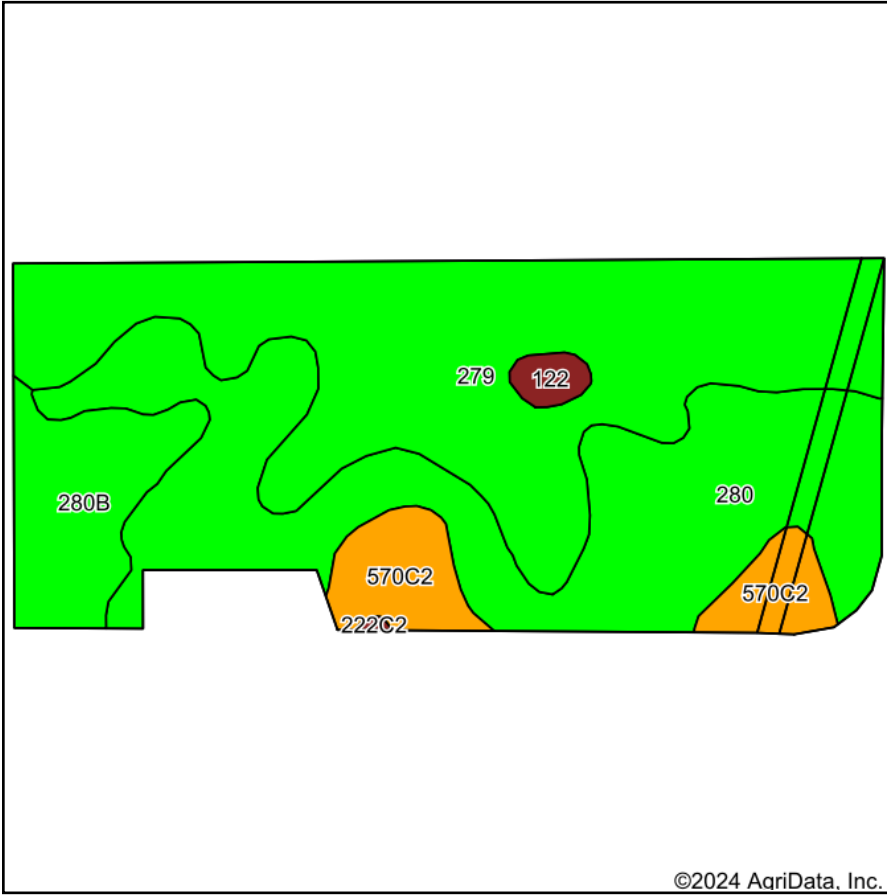

Soils data provided by USDA and NRCS.

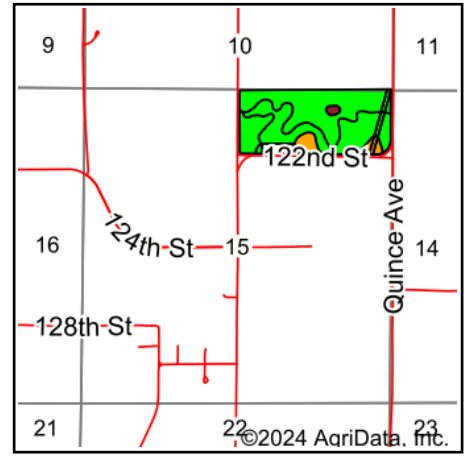

State: **Iowa**  
 County: **Jefferson**  
 Location: **15-73N-9W**  
 Township: **Penn**  
 Acres: **61.69**  
 Date: **6/13/2024**



Maps Provided By:  
  
 CUSTOMIZED ONLINE MAPPING  
 © AgriData, Inc. 2023 www.AgriDataInc.com



Area Symbol: IA101, Soil Area Version: 31

Code	Soil Description	Acres	Percent of field	CSR2 Legend	Non-Irr Class *c	CSR2**	CSR	
279	Taintor silty clay loam, 0 to 2 percent slopes	27.30	44.3%		IIw	83	88	
280	Mahaska silty clay loam, 0 to 2 percent slopes	23.15	37.5%		Iw	94	95	
280B	Mahaska silty clay loam, 2 to 5 percent slopes	5.84	9.5%		Ile	89	90	
570C2	Nira silty clay loam, 5 to 9 percent slopes, moderately eroded	4.64	7.5%		IIIe	70	67	
122	Sperry silt loam, depressional, 0 to 1 percent slopes	0.69	1.1%		IIIw	36	63	
222C2	Clarinda silty clay loam, 5 to 9 percent slopes, moderately eroded	0.07	0.1%		IVw	28	25	
<b>Weighted Average</b>						<b>1.71</b>	<b>86.1</b>	<b>88.9</b>

\*\*IA has updated the CSR values for each county to CSR2.

\*c: Using Capabilities Class Dominant Condition Aggregation Method