

Soils Map

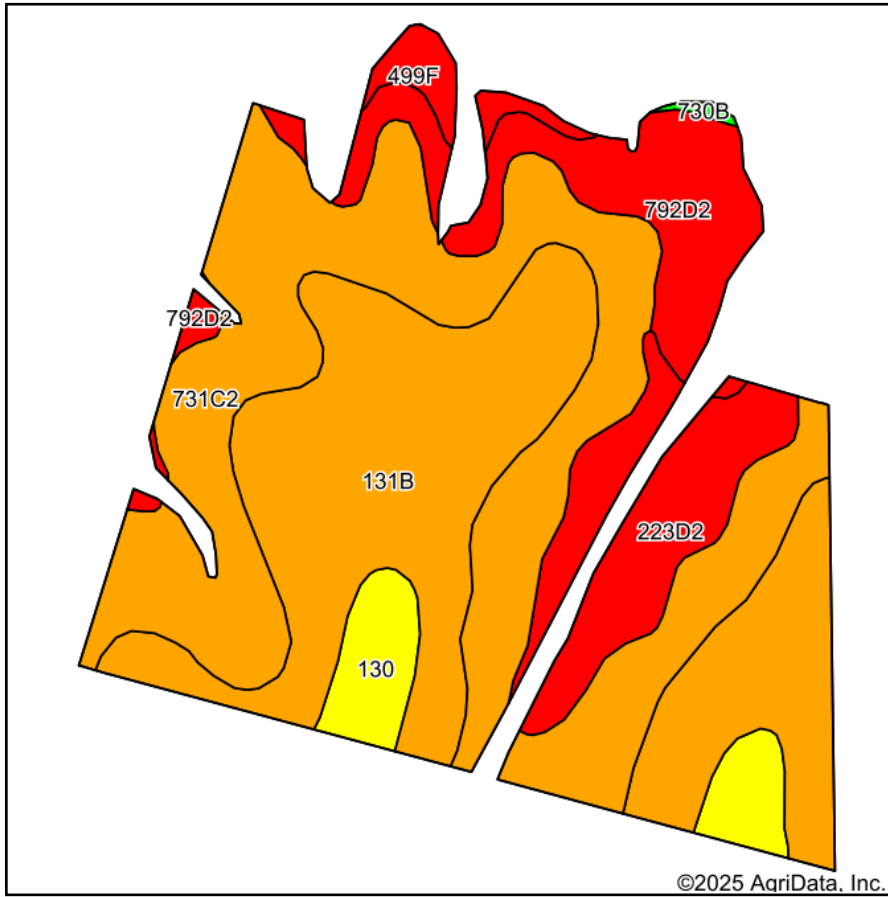

Soils data provided by USDA and NRCS.

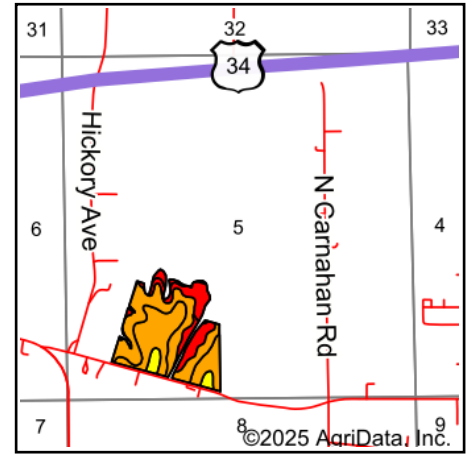

State: **Iowa**
 County: **Henry**
 Location: **5-71N-6W**
 Township: **Center**
 Acres: **44.15**
 Date: **4/7/2025**



Maps Provided By:

 CUSTOMIZED ONLINE MAPPING
 © AgriData, Inc. 2023 www.AgriDataInc.com



Area Symbol: IA087, Soil Area Version: 29

Code	Soil Description	Acres	Percent of field	CSR2 Legend	Non-Irr Class *c	CSR2**	CSR
731C2	Pershing silty clay loam, 5 to 9 percent slopes, moderately eroded	16.43	37.1%		IIIe	62	45
131B	Pershing silt loam, 2 to 5 percent slopes	15.44	35.0%		IIIe	70	67
792D2	Armstrong clay loam, 9 to 14 percent slopes, moderately eroded	4.71	10.7%		IVe	13	13
223D2	Rinda silty clay loam, 9 to 14 percent slopes, moderately eroded	4.38	9.9%		IVe	19	9
130	Belinda silt loam, 0 to 2 percent slopes	2.28	5.2%		IIIw	47	63
499F	Nordness silt loam, 14 to 25 percent slopes	0.82	1.9%		VIIIs	6	5
730B	Nodaway-Cantril complex, 2 to 5 percent slopes	0.09	0.2%		IIw	80	64
Weighted Average					3.28	53.5	45.9

**IA has updated the CSR values for each county to CSR2.

*c: Using Capabilities Class Dominant Condition Aggregation Method