

# Soils Map

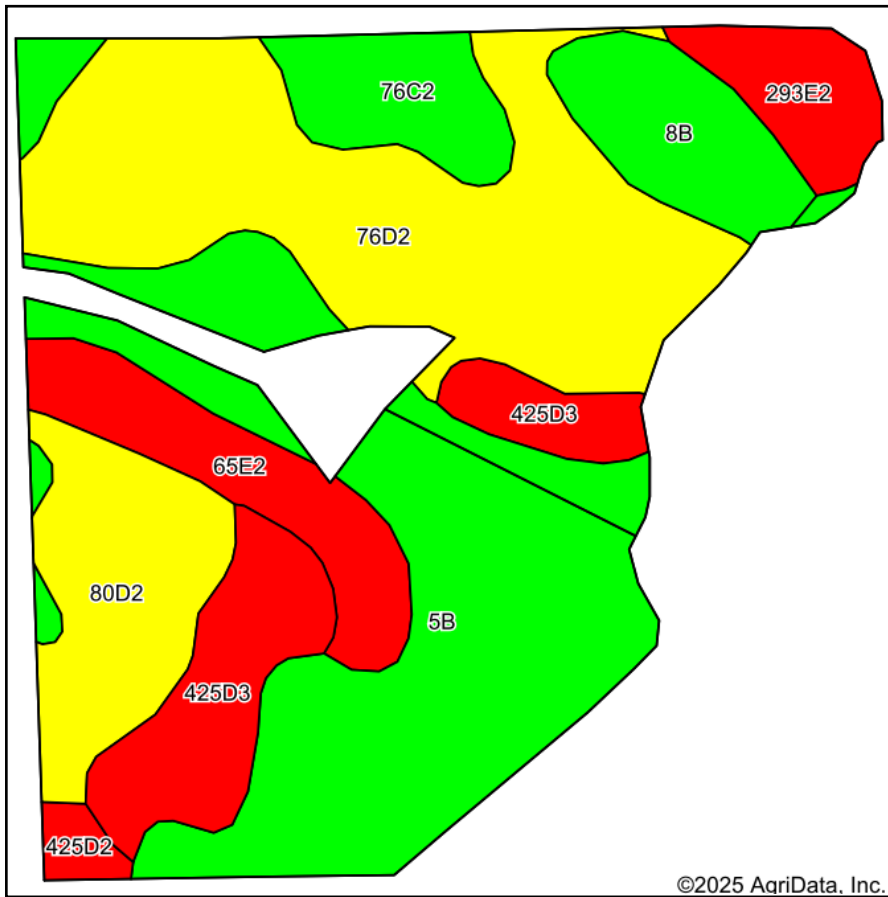

Soils data provided by USDA and NRCS.

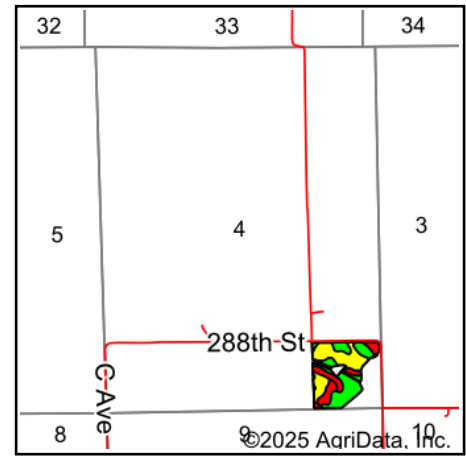

State: **Iowa**  
 County: **Iowa**  
 Location: **4-78N-12W**  
 Township: **Dayton**  
 Acres: **26.48**  
 Date: **3/31/2025**



Maps Provided By:  
**surety**  
 CUSTOMIZED ONLINE MAPPING  
 © AgriData, Inc. 2023 www.AgriDataInc.com



Area Symbol: IA095, Soil Area Version: 34

Code	Soil Description	Acres	Percent of field	CSR2 Legend	Non-Irr Class *c	CSR2**	CSR
5B	Ackmore-Colo complex, 2 to 5 percent slopes	7.65	29.0%		IIw	77	83
76D2	Ladoga silt loam, 9 to 14 percent slopes, eroded	7.18	27.1%		IIIe	49	55
425D3	Keswick clay loam, 9 to 14 percent slopes, severely eroded	2.59	9.8%		VIe	15	9
80D2	Clinton silty clay loam, 9 to 14 percent slopes, eroded	2.54	9.6%		IIIe	46	50
65E2	Lindley loam, 14 to 18 percent slopes, moderately eroded	1.89	7.1%		VIe	20	28
76C2	Ladoga silt loam, 5 to 9 percent slopes, eroded	1.72	6.5%		IIIe	75	65
8B	Judson silty clay loam, 2 to 5 percent slopes	1.60	6.0%		IIe	84	90
293E2	Fayette-Chelsea-Tell complex, 14 to 18 percent slopes, eroded	1.04	3.9%		IVe	18	18
425D2	Keswick silt loam, 9 to 14 percent slopes, moderately eroded	0.27	1.0%		IVe	13	12
Weighted Average					3.21	53.6	57.1

\*\*IA has updated the CSR values for each county to CSR2.

\*c: Using Capabilities Class Dominant Condition Aggregation Method

Soils data provided by USDA and NRCS.